

PNG Installation Guide

Euro Truck Simulator 2 / American Truck Simulator

Before You Begin

PNG is a massive project that affects many aspects of the game. For the first installation, it is recommended to clear the mod folder (remove other mods, older PNG files, fixes, etc.) to ensure everything works smoothly.

Add additional modifications step by step.

1. Installation

Extract the downloaded file using WINRAR or 7zip.

Open the extracted folder.

Move all files from 'Main Mod files' into:

Documents/Euro Truck Simulator 2/mod

ReShade Files

ReShade installation

Move preset files from 'Reshade presets' folder into:

Steam/steamapps/common/Euro Truck Simulator 2/bin/win_x64

Download ReShade 6.5.0 here:

https://reshade.me/downloads/ReShade_Setup_6.5.0.exe

IMPORTANT! The required version is 6.5.0.

[Open ReShade Download](#)

Install Downloaded ReShade

Install the downloaded ReShade package following the steps shown below. This image is kept on a separate page so the guide remains clean and the text does not overlap the screenshot.

1

or

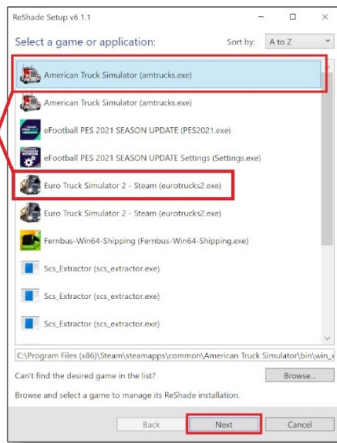

Select game install directory

or
\\Steam\steamapps\common\Euro Truck Simulator 2\bin\win_x64
or
\\Steam\steamapps\common\American Truck Simulator\bin\win_x64

And select .exe file:

or
\\eurotrucks2.exe
or
\\amtrucks.exe

2

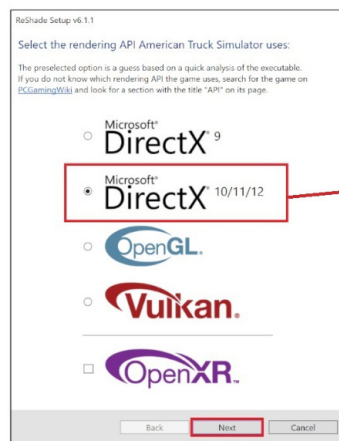

Select DirectX 10/11/12

3

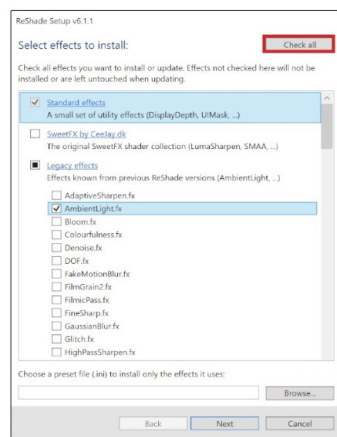

Click on "Check all" button to install all shaders.



ReShade - first start

Launch the game with DirectX 11 (64-bit), press the Home button, skip the tutorial if needed, and then select the correct preset as shown below.

1



Launch game with DirectX 11 (64-bit)

Press "Home" button

2

Select Preset:

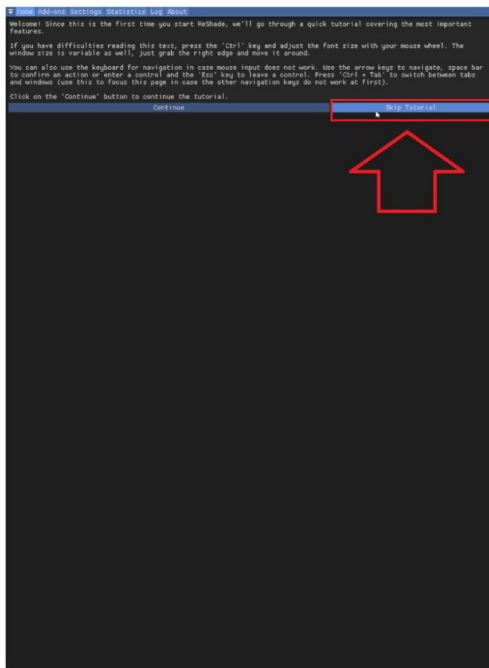

Mod Activation

Open Mod Manager in game and place PNG files in the correct load order. The layout below keeps the description on the left and the load-order image larger on the right.

Load Order Notes

Use the load order shown on the right.

Recommended rule:

- Keep FREE MODS at the top of the PNG section.
- For PE - SEASONS, use only 1 of 3 files.
- BASE Part is required.
- NorthExperience is a paid addon.
- PE Rain Addon and PE Weather parts go above the base materials.
- Map mods must be placed between BASE0 and BASE1.



Compatibility

- PNG is compatible with ProMods and other map mods.
- It is not recommended to use PNG together with other graphic mods.